

HUBBELL Power Systems

Terminal, Bronze Bolted

By ANDERSON
Catalog # [SWH080C](#)

Heavy duty, bronze alloy terminal, with 1/2" dia. Hex-head clamping bolts for connecting copper cable to copper flat. Side formed pads are standard for flush mounting. Clamping bolts have hex-stops for one-wrench installation. Tongue holes have NEMA spacing. All sizes furnished with reversible cable caps.

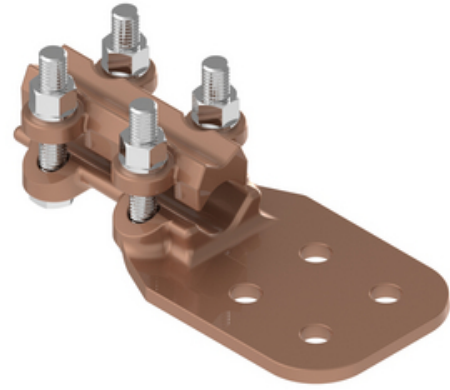

*Representative Image

Features

- 1/2" dia. Hex-head clamping bolts for clamping copper cable
- Side formed pads are standard for flush mounting
- Clamping bolts have hex-stops for one-wrench installation
- Tongue holes have NEMA spacing

General

Catalog Number	SWH080C
Material	Bronze
Material - Clamping Hardware	Stainless Steel
Number of Bolt Holes	4
Number of Ground Braid Lug Holes	0
Number of Pad Holes	4
Type	Bolted Lugs & Terminals
UPC	096359327530

Dimensions

Angle - Pad	180 °
Base Hole Spacing	0 in
Diameter - Base Holes	0 in
Diameter - Bolt	0 in
Diameter - Inside	0 in
Dimensions	6.5 in x 3 in x 1.5 in
Height	1.5 in
Length	6.5 in
Length - Coupling	0 in
Length Before Compression	0 in
Weight	3.01 lb
Width	3 in
Width - Pad	3 in

Electrical Ratings

Maximum Current Rating Amps 0
Continuous

Conductor Related

Conductor Diameter - Maximum	1.031 in
Conductor Diameter - Minimum	0.365 in
Conductor Diameter Range	0.365 - 1.031
Conductor Type	Copper

Logistics

Pallet Quantity	504
-----------------	-----

Product Assets

[Catalogs - Substation Connectors \(SA\)](#)

[Sales Drawings - C-2660](#)

[Video - Hubbell Power Systems 3D Portal to help with](#)

[developing 3D models of substation connector products](#)

[Video - Hubbell Power Systems Quick Ship](#)



A Hubbell brand

©2024 Hubbell Incorporated. All rights reserved
AN-SWH080C-SPEC-EN | REV 6/2024